

# Product leaflet

Product	Model No.	Ordering No.
Hood	SR 520 M/L	H06-0212
Hood	SR 520 S/M	H06-0312
Hood	SR 530	H06-0412

## Product Description

The hoods together with the battery-powered SR 500, SR 500 EX or SR 700 fan and approved filters are included in the Sundström fan-assisted respiratory protection device systems. The breathing hose of the hood is connected to the fan, equipped with a filter. The pressure generated in the hood prevents particles and other pollutants from entering the hood.

The hoods can also be used with the SR 507 compressed air equipment. This combination forms a breathing apparatus designed for continuous air flow, for connection to a compressed air supply.

The equipment can be used as an alternative to filter respirators in all situations for which filter respirators are recommended.

This applies particularly to work that is hard, warm or of long duration.

The SR 520 hood is available in two sizes, and the SR 530 hood is available in one size.

### The characteristics of the hoods are as follows:

Protects the respiratory organs and the crown of the head • Impact-resistant and chemical-resistant visor • The supply air keeps the visor demisted • Adjustable head harness • Permanently mounted, flexible breathing hose • Equipped with exhalation valve • Moreover, the SR 530 also protects the head and shoulders, is equipped with adjustable neck fit and the distance between the visor and the face is adjustable.

The hoods together with the SR 500 EX fan are approved for use in a potentially explosive atmosphere (ATEX Directive 94/9/EC and IECEx Scheme).

## Technical specification

	SR 520/SR 530 + SR 500/SR 500 EX/SR 700	EN 12941:1998 + A2:2008	SR 520 M/L, SR 530 + SR 507	EN 14594:2005
<b>Air flow rate</b>	175/240 l/min (SR 500) 175/225 l/min (SR 500 EX / SR 700)	≥ 120 l/min	175–260 l/min	-
<b>Service temperature</b>	-10 – +55 °C, < 90 % RH	-	-10 – +55 °C, < 90 % RH	-
<b>Storage temperature</b>	-20 – +40 °C, < 90 % RH	-	-20 – +40 °C, < 90 % RH	-
<b>Low flow warning level</b>	< 175 l/min	≤ 175 l/min	< 175 l/min	≤ 175 l/min
<b>Weight of SR 520/530 w hose</b>	≈ 360 g/480 g	≤ 1,500 g	≈ 360 g/480 g	≤ 1,500 g
<b>Working pressure</b>	-	-	5–7 bar	≤ 10 bar
<b>Assigned Protection Factor<sup>1</sup></b>	40 (TH3)	-	40 (3A,3B)	-
<b>Nominal Protection Factor<sup>2</sup></b>	500 (TH3)	-	200 (3A,3B)	-
<b>Approvals</b>	<b>Directive</b> PPE 89/686/EEC ATEX 94/9/EC  IECEx Scheme	<b>Standards</b> EN 12941:1998 + A2:2008, EN 14594:2005 EN 60079-0:2012, EN 60079-11:2007, EN 61241-11:2006, EN 13463-1:2009 IEC 60079-0:2011, IEC 60079-11:2006, IEC 61241-11:2005	<b>Classification/markings</b> TH3, Class 3A and 3B II 2 G Ex ib IIB T3 Gb <sup>3)</sup> II 2 D Ex ib IIIC T195°C Db <sup>3)</sup> Ex ib IIB T3 Gb <sup>3)</sup> Ex ib IIIC T195°C Db <sup>3)</sup>	

1) Specified in BS 4275 and applies generally to all approved fan-assisted respiratory protective devices, regardless of the test results.

2) According to EN 529:2005.

3) Together with fan SR 500 EX.

### Key to ATEX marking

<b>Ex</b>	Explosion protection mark.
<b>II</b>	Equipment group (explosive atmospheres other than mines with fire damp).
<b>2 G</b>	Equipment category (2 = High level of protection for Zone 1, G = Gas).
<b>2 D</b>	Equipment category (2 = High level of protection for Zone 21, D = Dust).
<b>Ex</b>	Explosion protected.
<b>ib</b>	Type of protection (Intrinsic safety).
<b>IIB</b>	Gas group (Ethylene).
<b>IIIC</b>	Dust material group (zone with conductive dust).
<b>T3</b>	Temperature class, gas (maximum surface temperature +200°C).
<b>T195°C</b>	Temperature class, dust (maximum surface temperature +195°C).
<b>Gb</b>	Equipment Protection Level, gas (high protection).
<b>Db</b>	Equipment Protection Level, dust (high protection).

### Key to IECEx marking

<b>Ex</b>	Explosion protected.
<b>ib</b>	Type of protection (Intrinsic safety).
<b>IIB</b>	Gas group (Ethylene).
<b>IIIC</b>	Dust material group (zone with conductive dust).
<b>T3</b>	Temperature class, gas (maximum surface temperature +200°C).
<b>T195°C</b>	Temperature class, dust (maximum surface temperature +195°C).
<b>Gb</b>	Equipment Protection Level, gas (high protection).
<b>Db</b>	Equipment Protection Level, dust (high protection).

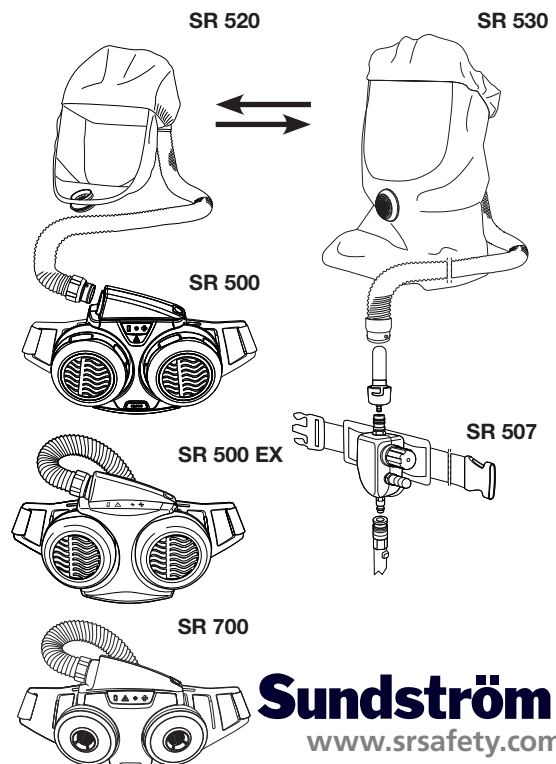

### Head Office

Tel: +46 10 484 87 00

Visiting address:  
Stockholmsvägen 33  
SE-181 33 Lidingö

### Factory

Tel: +46 10 484 87 00

Visiting address:  
Västergatan 4  
SE-341 50 Lagan

**Sundström**  
www.srsafety.com

# SR 520 Hood TH3

## Spare parts / Accessories

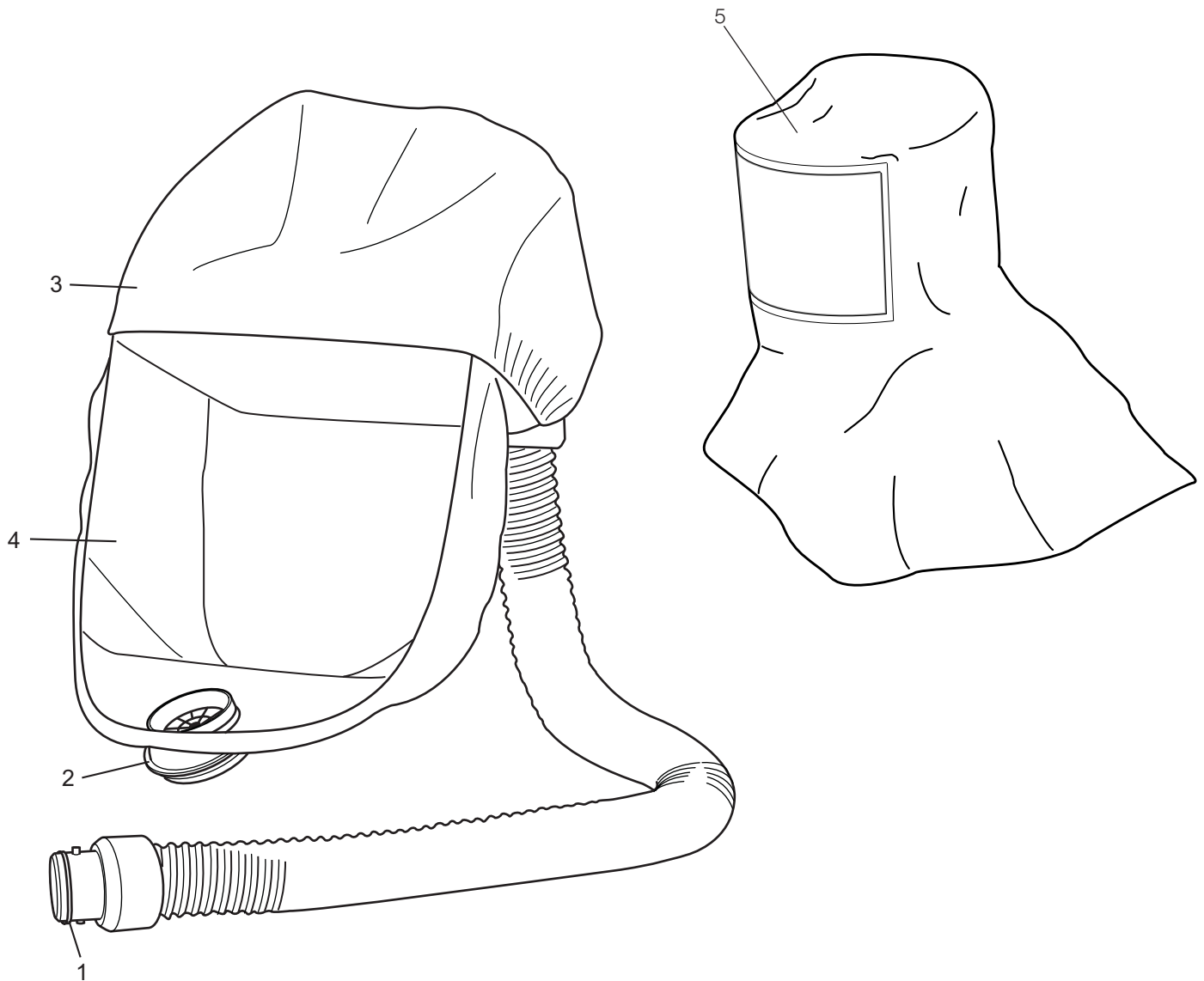

No.	Description	Ordering No.
1.	O-ring for breathing hose	R06-0202
2.	Set of valves for SR 520/SR 530	R06-0201
3.	Sweatband, SR 520/SR 530	R06-0203
4.	Peel-off set PETG, SR 520/SR530	T06-0201
5.	Tyvek Hood, SR 520/SR 530/SR 580	T06-0806
	Cleaning tissues SR 5226, box of 50	H09-0401